

## BLEX-017-R

BLEX-017-R is made from high quality aluminium designed to accommodate multiple strips for maximum illumination.

Supplied as standard in 1m or 2m lengths. We also offer cut-to-length option, further saving time and effort.

Contact our lighting specialist for more information!  
Samples available upon request.

### Features

- Easy to cut to size or extend as needed
  - Good heatsinking for LED longevity
  - Fitting colour can be customised\*
- \*may be subject to minimum order quantities

### Accessories



- 2 Poly end caps per standard length
- Diffuser - Frosted/Semi-clear/Clear
- 2 Mounting brackets per standard length

### Product Specifications

IP Rating	20
Dimensions (mm)	1000*57*35
Cut Out (mm)	1000*36
Weight (kg)	0.5
Warranty (yrs)	3

### Product Dimensions

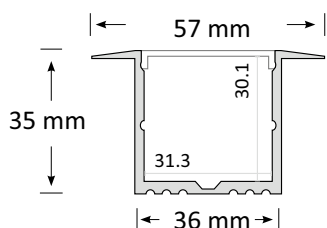

## Extrusion 017-R



### Installation Instruction

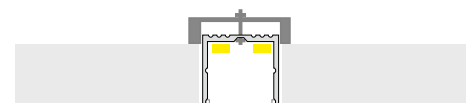

Extrusion can be recessed into benches, cabinets, shelves or furniture with the use of mounting bracket.

It can be fitted with multiple BoscoLighting SMD5050 or SMD3528 LED strips for interior lighting.

\*LEDs and driver not included.